

**ONE WAY VALVES**

**ACCESSORIES  
PNEUMATIC COMPONENTS**



UM series one way valves are used when there is the need to keep under pressure one tube, allowing, at the same time, the flow of air to one way.

**TECHNICAL DATA**

**CONSTRUCTIVE FEATURES**

<b>Fluid</b>	Filtered air		
<b>Operating pressure</b>	1 ÷ 10 bar		
<b>Temperature range</b>	-10°C ÷ +70°C		
<b>Materials</b>	Nickel plated brass - seals NBR		
<b>Flow rate NI/min.</b>	1/8"	1/4"	1/2"
	690	1230	3750
<b>Weight (g)</b>	56	98	223

**RANGE**

<b>Port</b>	<b>Model</b>
1/8"G	UM-8
1/4"G	UM-4
1/2"G	UM-2

**DIMENSIONS**

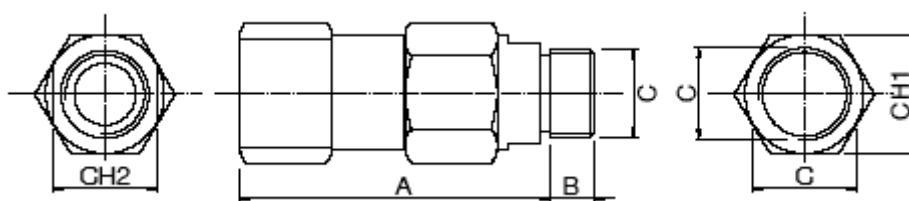

<b>Port</b>	<b>A</b>	<b>B</b>	<b>C</b>	<b>CH1</b>	<b>CH2</b>
1/8"G	47	6	1/8"	14	14
1/4"G	57	9	1/4"	19	17
1/2"G	69	12	1/2"	27	24